

LEGEND

- STORAGE AND SELLING OF ALCOHOL
- KITCHEN FACILITIES
- TOILET FACILITIES
- PERSONNEL ROUTES
- FIRE ESCAPE ROUTE
- FIRE ESCAPE DOOR
- PERSONNEL RESTRICTED ACCESS

- W WATER FIRE EXTINGUISHER
- P POWDER FIRE EXTINGUISHER
- CO₂ CARBON DIOXIDE FIRE EXTINGUISHER
- F FOAM FIRE EXTINGUISHER

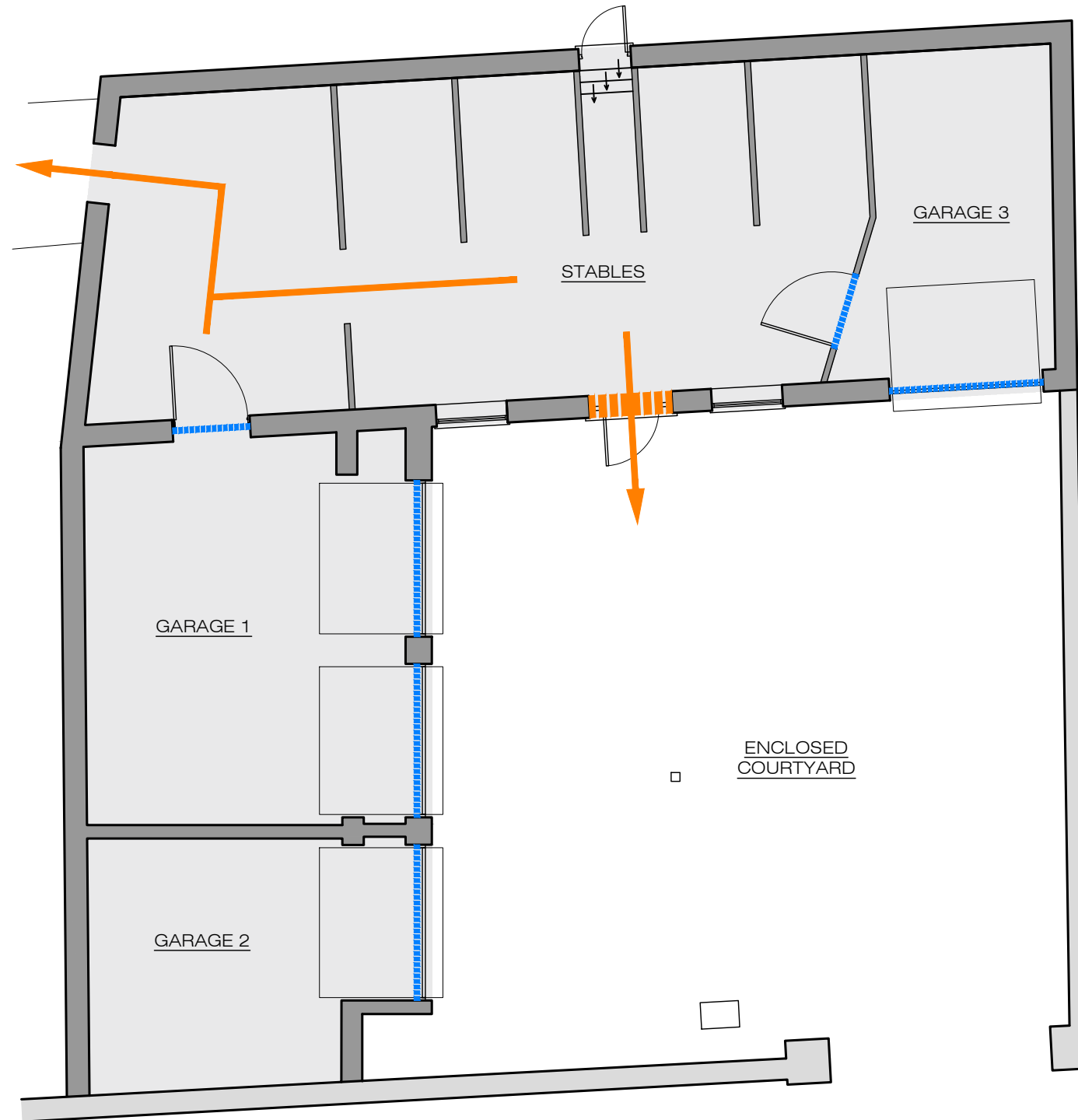

STABLES
SCALE: 1:100

NOTES:

THIS DOCUMENT IS THE PROPERTY OF J KNIGHT DESIGN LTD AND MAY NOT BE REISSUED, LOANED OR COPIED IN PART OR IN WHOLE WITHOUT WRITTEN PERMISSION © 2022

IT IS RECOMMENDED THAT INFORMATION IS NOT SCALED OFF THIS DRAWING. ALL DIMENSIONS ARE IN MILLIMETRES UNLESS STATED OTHERWISE.

THIS DRAWING SHOULD BE READ IN CONJUNCTION WITH ALL OTHER RELEVANT INFORMATION, SPECIFICATIONS & SCHEDULES.

IF THIS DRAWING IS RECEIVED ELECTRONICALLY IT IS THE RECIPIENTS RESPONSIBILITY TO PRINT THE DOCUMENT AT THE CORRECT SCALE.

ALL DIMENSIONS TO BE CHECKED ON SITE PRIOR TO COMMENCING WORK AND ANY DISCREPANCIES TO BE ADVISED IMMEDIATELY.

REF.	DATE	DESCRIPTION
-	-	-
REVISIONS AS ABOVE		

DRAWING STATUS:
AS BUILT

JKD

J KNIGHT DESIGN
ARCHITECTURAL SERVICES

T: 01945 479175
E: STUDIO@JKNIGHTDESIGN.COM
W: WWW.JKNIGHTDESIGN.COM

21 OLD CHURCH ROAD
TERRINGTON ST JOHN
WISBECH, NORFOLK, PE14 7XA

CLIENT INFORMATION:

ELGOODS & SONS LTD
72 NORTH BRINK
WISBECH
PE12 1LW

PROJECT TITLE:
PREMISES ALCOHOL LICENSE APPLICATION

DRAWING INFORMATION:
**EXISTING FLOOR PLAN
STABLES**

SCALE:	DATE:	DRAWN BY:
1:100 @ A3	NOV 2022	JCK
DRAWING REFERENCE:	REVISION:	

22112-P005

CHECKED / ISSUED BY:	DATE: